

THE ROSLIN BEACH HOTEL

THORPE ESPLANADE, THORPE BAY, ESSEX, SS1 3BG

Do not scale this drawing. Work to figured dimensions only. This drawing is copyright of APS Designs and should only be reproduced with their express permission. Check all dimensions on site. Any discrepancies should be reported to APS Designs prior to commencement.

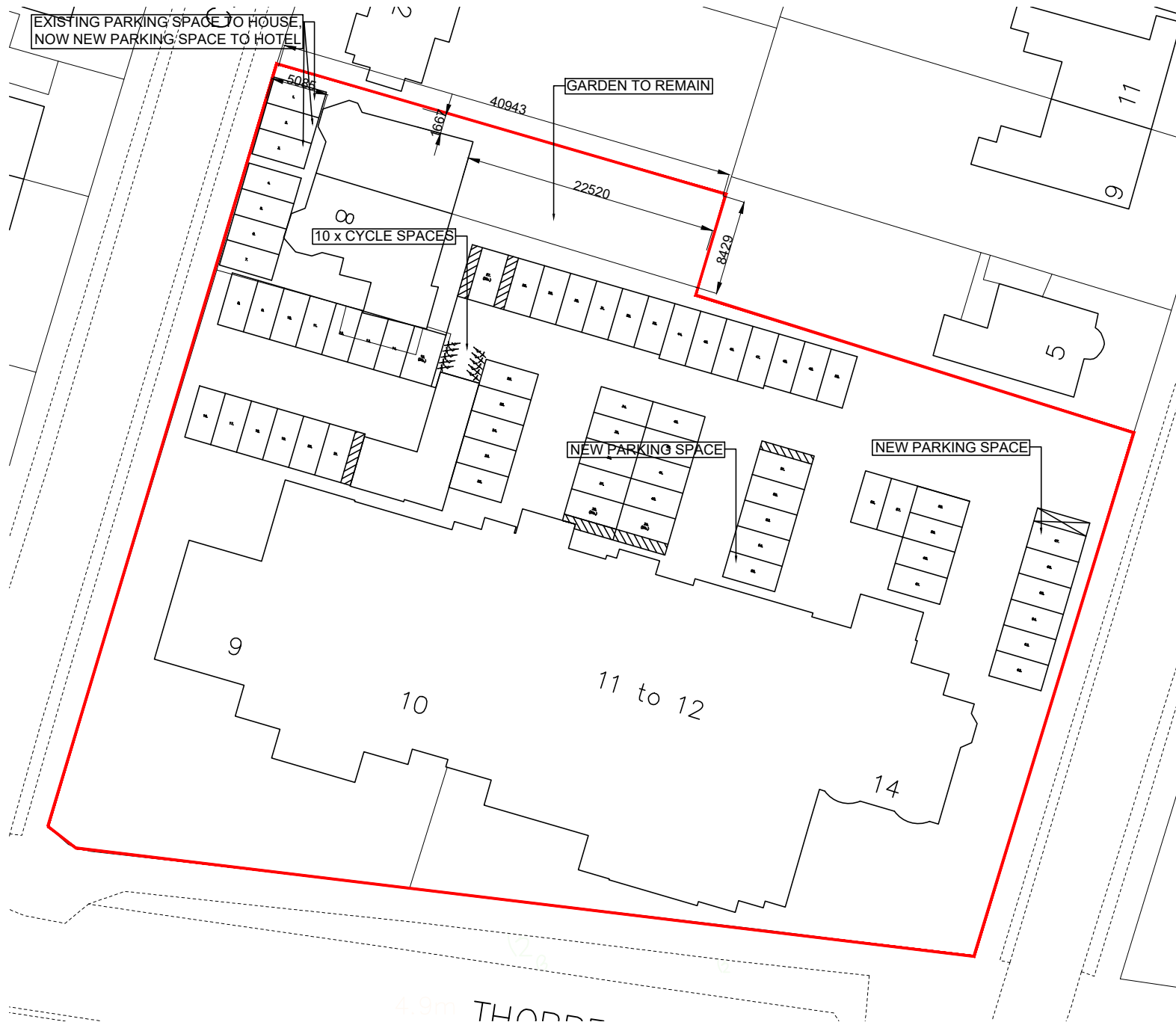

1 Proposed Site Plan

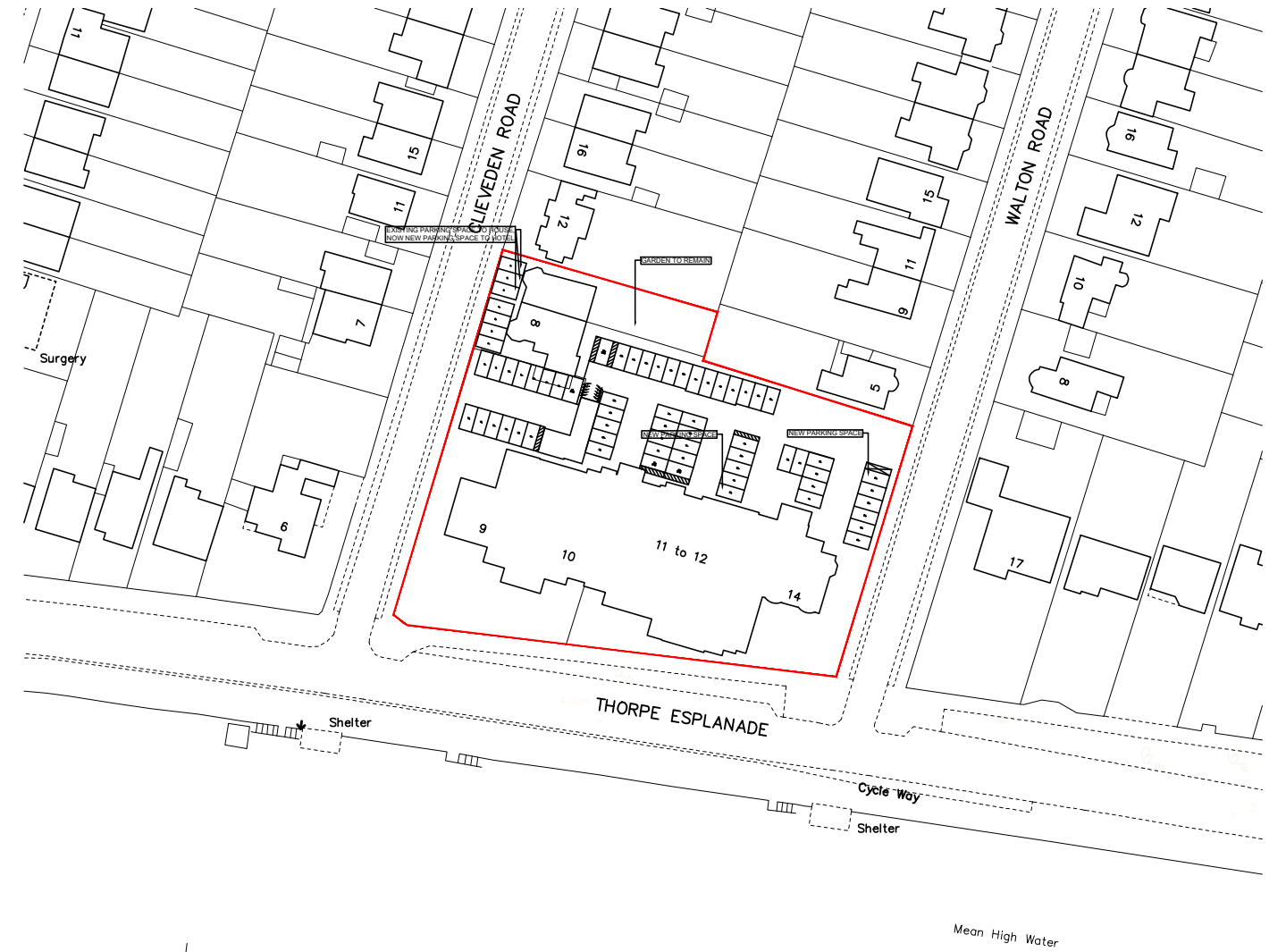
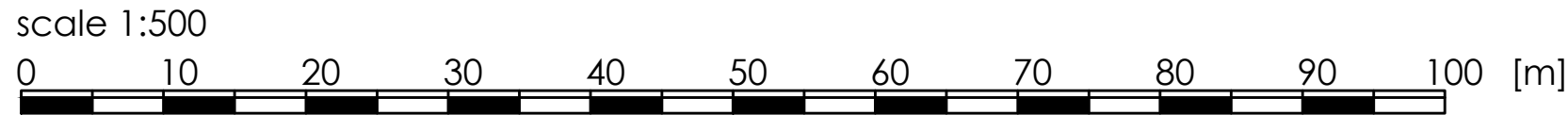
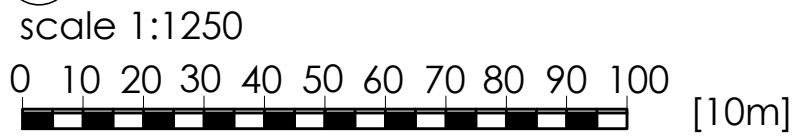

2 Proposed Location Plan

Scale: 1:1250

REV A	27.10.2016	Amendments to parking
REV A	20.10.2016	Amendments made in line with invalid letter dated 19.10.16
REVISION	DATE	AMENDMENT

APS DESIGN ASSOCIATES LTD
ARCHITECTURAL DESIGNERS AND PLANNING CONSULTANTS

PROJECT STAGE: TOWN PLANNING
DRAWN BY:
DATE: 27.10.2016

CLIENT:

PROJECT:
The Roslin Beach Hotel-Business centre

JOB NO: 2421
DRAWING NO: 01b

REVISION:

DRAWING TITLE:
Proposed Location Plan and Site Plan

SCALE:
1:1250 / 1:500 @ A3

The Design Studio
1 Cambridge Road (Rear)
Nelson Street
Southend-On-Sea
Essex
SS1 1ET

Tel: 01702 469 769 - 01702 337328
Email: admin@apsdesignsuk.com
designteam@apsdesignsuk.com
planning@apsdesignsuk.com
Website: www.apsdesignsuk.com

